

KEDA
SureMaker



微信公众号



官方抖音



YOUTUBE

安徽科达机电股份有限公司
ANHUI KEDA INDUSTRIAL CO.,LTD



全国销售热线:

4006-600-499



CHINESE WEBSITE: www.keda-suremaker.cn

FOREIGN WEBSITE: www.keda-suremaker.com



公司地址: 安徽省马鞍山市经济技术开发区天门大道南段2887号

Economic & Technological Development Zone, Ma'anshan, Anhui Prov., China

科达新铭丰

KEDA SUREMAKER



做世界一流的蒸压加气混凝土整线系统供应商
TO BE A WORLD-CLASS SUPPLIER OF AAC PLANT SOLUTION

企业愿景 VISION

做世界一流的蒸压加气混凝土整线系统供应商
To Be A World-Class AAC Plant Solution Supplier

企业使命 MISSION

让幸福更久远 — 为节能减排提供装备与服务
Green solution, Greener Life

企业核心价值观 CORE VALUE

创新永无止尽，为客户创造价值
Innovate Infinitely, Create Value For Customer

诚实守信，多赢才是赢
To Be Honest, Multi-win with Credibility

品质至上，质量决定成败
Quality First, Quality Decides Success Or Failure

集团介绍 GROUP INTRODUCTION

科达制造股份有限公司创建于1992年，于2002年在上交所上市（股票代码：600499），在全球拥有60余家子公司，业务涵盖陶瓷机械、墙材机械、石材机械等建材机械、海外陶瓷生产及销售、节能环保、锂电材料、液压泵、流体机械、智慧能源等。在印度、土耳其、意大利等国家成立了子公司，在全球建立10余个研发生产基地，进行“海外合资建厂+整线销售+技术工艺服务”企业战略部署，推进科达全球化布局进程。

拥有知名建材机械品牌：科达（KEDA）、新铭丰（SUREMAKER）、恒力泰（HLT）、德力泰（DLT）、唯高（WELKO）、特福（TWYFORD）等行业知名品牌，产品销往50多个国家和地区。

KEDA INDUSTRIAL GROUP CO., LTD. was founded in 1992 and listed in Shanghai Stock Exchange in 2002 (stock code: 600499). Its business covers ceramic machinery, brick machinery, stone machinery and other building materials machinery manufacturing & sale, overseas ceramic tile production, clean energy environmental protection equipment, lithium battery materials, hydraulic pumps, fluid machinery, smart energy etc. In recent years, KEDA established subsidiaries in India, Turkey and Europe successively. Meanwhile, KEDA insists on the strategic deployment "joint-venture + complete plant sale + knowhow services" which steadily advanced the progress of KEDA globalization.

KEDA products have been sold to more than 50 countries and regions, and have owned many famous brands in the industry, such as KEDA, HLT, DLT, Welko, Twyford, SureMaker, etc.



科达全球业务版图

BUSINESS MAP

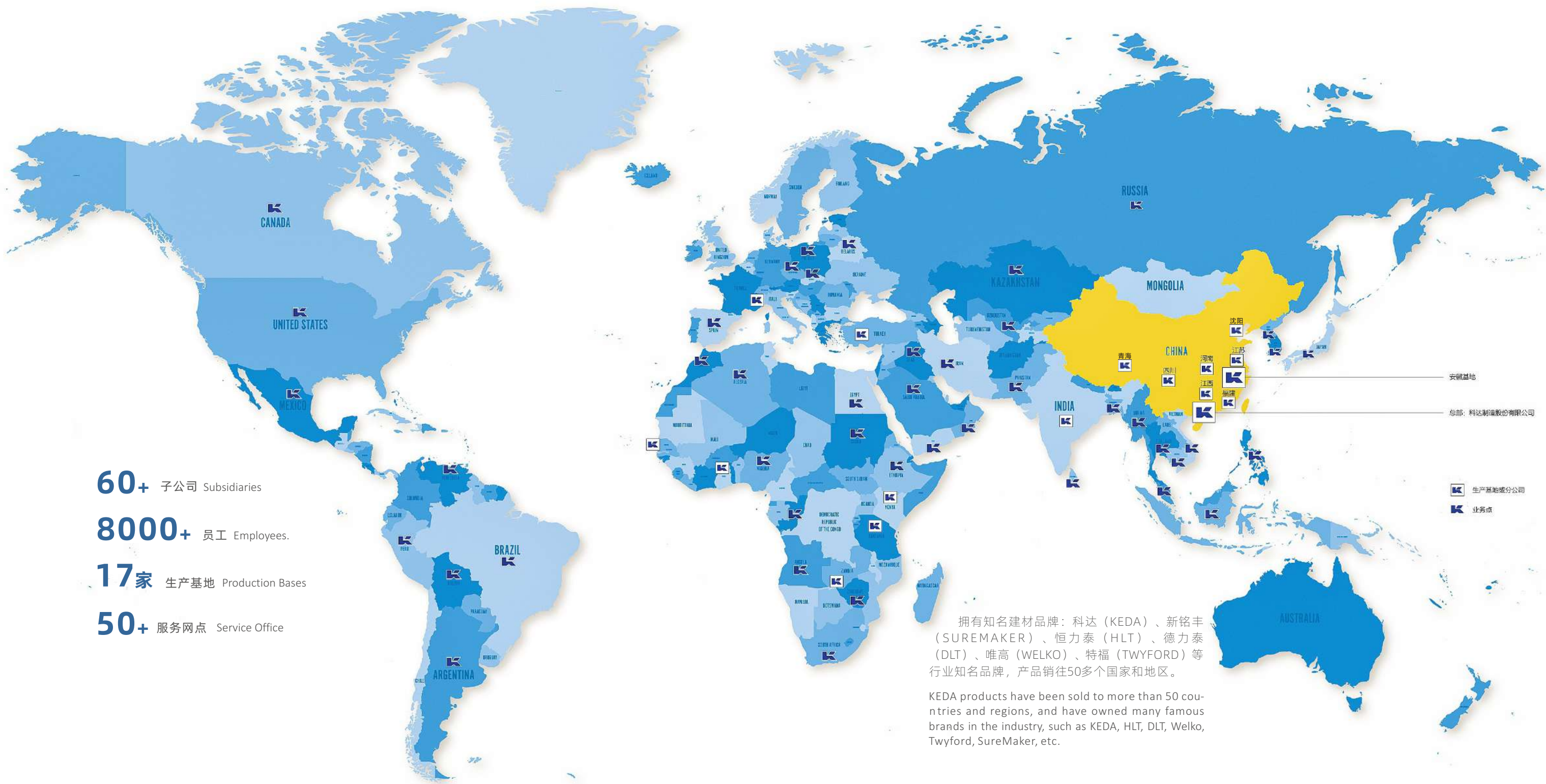

60+ 子公司 Subsidiaries
8000+ 员工 Employees.
17家 生产基地 Production Bases
50+ 服务网点 Service Office

拥有知名建材品牌：科达 (KEDA)、新铭丰 (SUREMAKER)、恒力泰 (HLT)、德力泰 (DLT)、唯高 (WELKO)、特福 (TWYFORD) 等行业知名品牌，产品销往50多个国家和地区。

KEDA products have been sold to more than 50 countries and regions, and have owned many famous brands in the industry, such as KEDA, HLT, DLT, Welko, Twyford, SureMaker, etc.

企业介绍

ABOUT US

安徽科达机电股份有限公司（科达新铭丰）坐落于安徽省马鞍山市，是科达制造股份有限公司的控股子公司，是一家集蒸压加气混凝土砌块/板材生产线工艺服务、整线规划、设计研发、装备制造、工程服务、人才培养、产品应用和运营管理咨询为一体的整线系统解决方案供应商。

Anhui KEDA Industrial Co., Ltd. (KEDA SUREMAKER), located in Ma'anshan City, Anhui Province, is the holding subsidiary of KEDA Industrial Group Co., Ltd. We providing customers with holistic AAC plant solutions including production process and formula design, equipment R&D, manufacturing, plant engineering, personnel training, operation management and product application consulting, etc.

国家高新技术企业
National High-tech Enterprise

中国加气混凝土协会副会长单位
Vice President Unit of China Aerated Concrete Association

欧洲蒸压加气混凝土协会会员单位
Associated Member of European AAC Association

安徽省墙体材料革新和建筑材料节能协会名誉会长单位
President Unit of Anhui Wall Materials Innovation Association

国家“十三五”重点计划项目研发基地
R&D Base of the National "13th Five year plan" key projects

国家级博士后科研工作站分站
National Postdoctoral Research Work Station

省级企业技术中心
Provincial Enterprise Technology Center

省级工程技术研究中心
Provincial Engineering Technology Research Center





发展历史 蒸压加气混凝土的起源

Origin of Autoclaved Aerated Concrete

AAC最早于20世纪20年代在瑞典发展起来，当时一位建筑师阿克塞尔·埃里克森首先将水泥、石灰、水和沙子的传统混凝土混合物与少量铝粉混合。

AAC was first developed in Sweden in 1920s, when an architect Axel Eriksson first combined the conventional concrete mixture of cement, lime, water, and sand with a small amount of aluminum powder.

1929年，瑞典建成世界首座蒸压加气混凝土工厂，之后北欧形成了“伊通”和“西波列克斯”两大生产工艺体系，产生了一批高端供应商，逐渐将AAC发展到整个欧洲乃至全世界。

In 1929, the world's first AAC plant was built in Sweden, then "Ytong" & "Siporex" two production process systems were gradually formed in northern Europe and several high-end equipment suppliers appeared, and then AAC was gradually developed to the whole Europe and even all over the world.

中国蒸压加气混凝土 发展起步试制阶段

Development of AAC In China
Period of Initial Trial Production

1958-1962年，中国建筑科学研究院组织学者研究试制AAC。

In 1958-1962, the Chinese Academy of Building Sciences organized experts to study and trial produce

1965年，北京市加气混凝土厂引进瑞典西波列克斯装备技术，是中国首家AAC工厂。之后，AAC行业在中国进入缓慢发展期。

In 1965, the first AAC plant in China was built with Siporex technology, then China AAC industry entered a slow development period.

1992年，国务院出台《关于加快墙体材料革新和推广节能建筑意见的通知》，从此拉开“新型墙体材料时代”的帷幕，AAC砌块逐步取代实心粘土砖，成为主流墙材。

In 1992, the State Council issued the "Notice on accelerating the innovation of wall materials and promoting energy-saving buildings", China entered the new wall materials era, then AAC block gradually replaced solid clay brick to be the main wall material.

中国蒸压加气混凝土发展 行业新兴阶段

Development of AAC in China
Period of The Industry Emerging

1995年，南京建通引进德国威翰二手设备，时任武汉建材研究院工程师的徐顺武先生对设备进行改造，使其可以在中国平稳生产。

In 1995, Nanjing JT imported the second-hand equipment of Wehrhahn. Mr. XuShunwu, who was the engineer of Wuhan Building Materials Research Institute, upgraded the equipment to produce AAC smoothly.

1996年，中国南京旭建新型建材股份有限公司从日本引进瑞典西波列克斯的二手切割机及技术图纸，徐顺武先生负责该项目配套设备的总设计工作。

In 1996, China Xujian imported second-hand cutting machines of Siporex plant from Japan. Mr. Xu Shunwu was responsible for the overall design of auxiliary machines.

2003年，胜利油田营海实业集团从韩国引进了威翰的二手设备，徐顺武先生对整厂进行了自动化改造升级。

In 2003, Yinghai Industrial Group imported the second-hand equipment of Wehrhahn from South Korea, and Mr. Xu Shunwu upgraded the automation level of the plant.

中国蒸压加气混凝土发展 装备本土化生产阶段

Development of AAC in China
Period of Localized Production

2004年，徐顺武先生成立武汉新新铭丰建材技术开发有限公司。

In 2004, Mr. Xu Shunwu established Wuhan Suremaker Building Materials Technology Development Co., Ltd.

2006年，武汉新新铭丰为德国凯莱集团在中国长兴建立的长兴伊通有限公司提供配套设备。

In 2006, Wuhan Suremaker provided the auxiliary machines for the AAC plant of Changxing Ytong Co., Ltd. established by Kella group in Changxing, China.

2007年，武汉新新铭丰在滁州博奥建成第一条中国本土化全自动化的蒸压加气混凝土砌块生产线。

In 2007, Wuhan Suremaker built China's first automatic AAC block plant in Anhui province.

2008年，芜湖新铭丰机械装备有限公司成立。同年为德国凯莱集团在中国天津建立的凯莱建筑材料有限公司提供配套设备。

In 2008, Wuhu Suremaker Industrial Co., Ltd was established, and provided the auxiliary machines for Kella Tianjin AAC plant.

2011年，芜湖新铭丰在山东建成中国第一条高端智能的蒸压加气混凝土板材生产线。同年，生产线出口到越南和印度尼西亚。

In 2011, Wuhan Suremaker built China's first high-end intelligent AAC panel plant in Shandong province. In the same year, Suremaker production lines was exported to Vietnam & Indonesia.

2012年，科达机电与新铭丰强强联手，改变了传统的蒸压加气混凝土装备销售模式，致力于为客户提供整线系统解决方案，推动行业发展。

In 2012, KEDA cooperated with SUREMAKER to build the KEDA SUREMAKER brand, then the company changed from an equipment manufacturer to a holistic AAC plant solution supplier.

中国蒸压加气混凝土 行业的高速发展期

Development of AAC In China
Period of Rapid Development

2018年，科达新铭丰作为唯一一家中国AAC装备企业受邀参加在德国波茨坦举办的第六届世界蒸压加气混凝土大会并发表专业学术演讲。

Attended the 6th International AAC Conference in 2018 and made a speech on customized AAC equipment.

至今，科达新铭丰的生产线已遍布中国30个省级行政区，出口至东南亚，中亚，中东，欧洲及拉美等世界各地。

Up to now, the AAC plants of KEDA SUREMAKER have been installed all over 30 provincials in China and exported to Asia, Middle East, Europe, Latin America & other area of the world.

科达新铭丰的专家领导团队，相继参与编制了5项国家标准主编及参编12项行业标准及2项团标。

KEDA SUREMAKER successively edited 5 national standards, 12 industry standards and 2 group standards.

引领国家及行业标准

LEADING THE STANDARDIZATION WORK

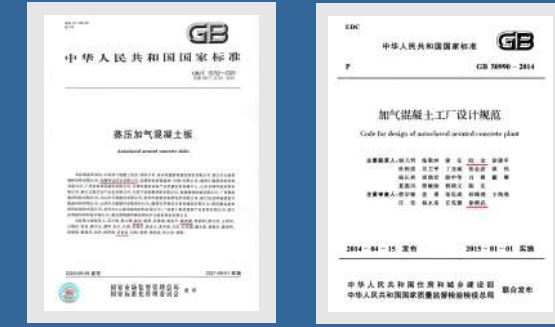

主编及参编5项国家标准、12项蒸压加气混凝土的核心设备行业标准及2项团体标准,其中包括《蒸压加气混凝土板》、《蒸压加气混凝土砌块》、《加气混凝土工厂设计规范》、《蒸压加气混凝土切割机》《蒸压加气混凝土设备 空翻脱模机》《蒸压加气混凝土单位产品能耗限额及计算方法》等。

We have successively edited 5 national standards, 12 AAC industry standards and 2 group standards.

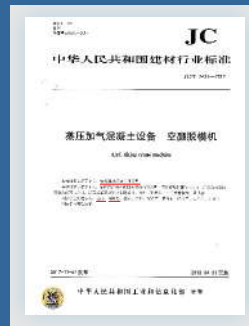

企业荣誉

COMPANY HONOR



引领行业发展 LEADING THE INDUSTRY DEVELOPMENT



2019年，科达新铭丰承办“中国加气混凝土协会第39次年会暨2019AAC国际论坛”，吸引来自国内外约800多位参会者以及50多家业内企业参加。



The 39th annual meeting of China Aerated Concrete Association and 2019 AAC International Forum was held by KEDA SUREMAKER successfully, which attracted more than 800 participants.



“十三五”国家重点研发基地 The National 13th Five-year Plan R&D Base In KEDA



第六届世界蒸压加气混凝土大会 The 6th International AAC Conference

科达新铭丰受邀前往德国波茨坦大学，参加第六届世界蒸压加气混凝土大会。期间，总经理陈新疆先生发表专业学术演讲。

In 2018, Mr. Chadwick, MD of KEDA SUREMAKER, attended the 6th International AAC Conference and delivered a speech on customized AAC equipment.



蒸压加气混凝土技术起源于欧洲，欧洲蒸压加气混凝土协会成立于1988年，拥有高端加气生产工艺技术研发中心，其成员在欧洲19个国家拥有100多个生产基地，注重行业与智慧城市的可持续发展。

为促进世界蒸压加气混凝土行业的交流与发展，2021年科达新铭丰总经理陈新疆先生代表公司受邀参加欧洲蒸压加气混凝土协会执行委员会线上会议。经现场演讲及投票，作为亚洲唯一一家蒸压加气混凝土设备制造商，与欧洲顶尖品牌威翰同时入选加入欧洲蒸压加气混凝土协会，成为会员单位。

The European Autoclaved Aerated Concrete Association was founded in 1988, with members from 19 countries operating more than 100 production sites. In order to further promote the worldwide AAC industry together, KEDA SUREMAKER joined EAAACA as an associated member in 2021.



研发与创新

RESEARCH, DEVELOPMENT, INNOVATION



公司一直以技术创新为企业核心驱动力，技术中心现有技术研发人员占比达员工总人数的30%以上。拥有多功能实验系统，设立多个专业技术研究机构、1个博士后科研工作站。长年和国内知名高校进行院校合作，如和同济大学联合研究专业课题，承接十三五国家课题子课题-节能墙体材料部品化绿色制备工艺技术与装备研发。

We always take technological innovation as the core driving force. 30% of our employees are engaged in technology research and development. With our own professional technical research institutions and post doctoral research stations, we cooperate with Tongji University for further research and has undertaken the 13th five year national project.

技术中心设有独立的研发部、电气实验中心及新产品研发测试中心。研发成果除在公司内进行审核检测外，经常邀请西门子、施耐德等国际知名供应商进行联合测评。

Our R&D achievements are tested in the technology center of the company, and we usually invite Siemens, Schneider and other international well-known suppliers to conduct joint evaluation.



截止2021年，累计获得发明专利101项，实用新型专利183项
101 invention patents & 183 utility model patents until 2021



2003 —— 初代产品
开创国内先河，人机分离操作模式。
2003 — The First Generation:
Automatic AAC plant

2017 —— 三代产品
现代化高端工厂设计：整厂自动化水平提升，切割水平提升，设备设计由装配式结构取代传统焊接，提高现场安装效率及设备美观度。
2017 — The Third Generation:
Modern high-end AAC plant Improve on automation and equipment structure.

2011 —— 二代产品
自动化板材工厂设计：设备标准化，提高可维护保养性。
2011 — The Second Generation:
Automatic AAC panel plant Equipment Standardization, Improve on maintainability.

2021 —— 第四代产品
大产能智能工厂设计：大产能升级与智能化提升，设备实用性功能拓展，提升整厂运行效率。机、电、液高度集成标准化设计，整厂工业美学设计。
2021 — The Fourth Generation
Large capacity upgrading and intelligent promotion, highly integrated standardized design, industrial aesthetic design.



技术人员中高级职称占23.6%、中级职称占35.2%、初级职称41.2%。学习是创新的源泉，公司始终坚持建立学习型组织，为技术创新提供有力保障。信息化管理平台，实现全流程管控，为客户提供高效、优质的产品与服务。

The company has always been taking technological innovation as the core driving force of the enterprise, with technical R&D personnel accounting for more than 30% of the total number of employees, including 23.6% of senior professional titles, 35.2% of intermediate professional titles and 41.2% of junior professional titles.

合作品牌 Co-Branding



绿色工厂 MANUFACTURE CENTER

生产制造基地拥有下料车间、重型铆焊车间、机加工车间、数控加工中心车间、油漆车间，装配车间、成品仓库、电气车间、新产品研发测试中心。引进国内外先进设备，如：龙门火焰切割机、等离子切割机、大型折弯成型设备、松下工业机器人、松下二氧化碳数字焊机、林肯埋弧焊、光谱分析仪、X射线射线探伤、C型支撑式双工位自动机器人焊接系统、井式退火及调质炉热处理设备、大型自动抛丸喷涂生产线、14米齐二数控镗铣床、8米数控龙门镗铣加工中心、4米数控镗铣加工中心、TK6920大型落地镗、小巨人立式及卧式加工中心、五轴加工中心、雕刻机、260T起重设备等，可年产50条AAC生产线。

The production and manufacturing base has blanking workshop, welding workshop, machining workshop, CNC machining center workshop, painting workshop, assembly workshop, finished product warehouse, electrical workshop and new product R&D and testing center. Introduce advanced equipment, such as gantry flame cutting machine, plasma cutting machine, large bending and forming equipment, Panasonic industrial robot, Panasonic carbon dioxide digital welding machine, Lincoln submerged arc welding, spectrum analyzer, X-ray flaw detection, C-type supporting double station automatic robot welding system, well annealing and quenching and tempering furnace heat treatment equipment, large-scale automatic shot blasting and spraying production line, 14m NC boring and milling machine, 8m CNC gantry boring and milling machining center, 4m CNC boring and milling machining center, TK6920 large floor boring, small giant vertical and horizontal machining center, five axis machining center, engraving machine, 260t large lifting equipment, etc., with the processing and manufacturing capacity of 50 AAC production lines per year.



制造工程师队伍涵盖焊接、机加工、数控、检测等多专业领域，具备焊接相关项目资质83项。同时拥有SAP集成系统、MES车间管理系统、SCM供应链管理系统以及OA自动化办公系统等先进的生产信息化管理系统，覆盖计划、排产、物料配送、检验确认、办公等各个环节，使产品生产进度和质量在加工制造过程中得到有效控制。

The manufacturing engineer team covers welding, machining, numerical control, testing and other professional fields, with 83 welding related project qualifications. The product production progress and quality can be effectively controlled in the process of processing and manufacturing with SAP integrated system, MES workshop management system, SCM supply chain management system, OA automation office system and other advanced production information management systems, covering planning, production scheduling, material distribution, inspection and confirmation, office etc.



工艺实验

PROCESS TECHNOLOGY EXPERIMENTAL



工艺实验中心设置化学分析室、仪器室、工艺室，配置有扫描电镜、X-射线衍射仪、激光粒度仪等高精实验仪器。可开展粒度分析、光谱分析、化学分析、物相分析、微观形貌分析等专项试验分析。 可以为客户提供全方位综合性服务，包括原料分析，工艺实验，现场生产，人员培训等全生命周期服务支持。

The process experiment center is composed of chemical analysis room, instrument room and process room, and equipped with scanning electron microscope, X-ray diffractometer, laser particle sizer and many other instruments and equipment, which can carry out particle size analysis, spectral analysis, chemical analysis, phase analysis, micro morphology analysis, etc. Providing customers with a full range of comprehensive services, including raw material analysis, process experiment, on-site production, personnel training and life cycle service support.

应用研究

APPLICATION RESEARCH

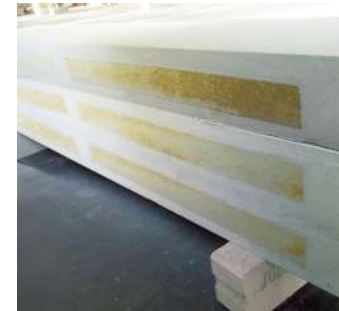

自保温蒸压加气混凝土板
Self-thermal Insulation AAC Panel



保温结构一体化板
Integrated Thermal Insulation Board



超低密度砌块
Ultra low density AAC block

建筑安全事故总量持续高位，全球劳动力短缺带动建筑机器人行业需求。建筑机器人可以减轻工人劳动强度，提高建筑行业砌筑施工的自动化程度，是今后发展墙体一体化部品拼装生产线的关键装备。

The global labor shortage drives the demand of the construction robot industry. The construction robot can reduce the labor intensity of workers and improve the automation of masonry construction in the construction industry. It is the key equipment for developing the wall integrated component assembly production line in the future.



蒸压加气混凝土建筑系统应用与施工工艺研究 Autoclaved Aerated Concrete Application System

- AAC Panel Exterior Wall Panel 蒸压加气混凝土板外墙体系
- Waterproof Interface Agent 加气混凝土专用防水界面剂
- Crack-resistant Mortar 抗裂砂浆
- Alkali-Resistant Glass fiber Gridding Cloth 耐碱玻纤网格布
- Base Putty For Coatings 涂料腻子
- Exterior Paint 外墙涂料

内墙保温砌块
Blocks (Inside Wall)



保温楼板
Floor Panel

- 内隔墙板饰面系统 AAC Panel Interior Wall Decoration System
- 建筑内墙用底层腻子 Base Putty For Building Interior Wall
- 建筑内墙用面层腻子 Finish Putty For Building Interior Wall
- 内墙涂料 Interior Paint
- 内墙壁纸 Interior Wall Paper

- 蒸压加气混凝土外墙饰面体系 AAC Exterior Wall Decoration System
- 加气混凝土专用防水界面剂 Waterproof Interface Agent
- 抗裂砂浆 Crack-Resistant Mortar
- 耐碱玻纤网格布 Alkali-Resistant Glass Fiber Gridding Cloth
- 瓷砖胶粘剂 Tile Adhesive
- 仿真饰面砖 Simulated Decorative Surface Tiles

为何选择科达新铭丰？

WHY CHOOSE KEDA SUREMAKER ?

符合发展趋势

Meet The Development Trends

装配式建筑发展、碳达峰和碳中和、固体废物处理。

Prefabricated building development trend, requirement of net-zero carbon emission and solid waste treatment.

品牌口碑

Brand Reputation

中国加气协会副会长单位、欧洲加气协会指定合作会员单位、国标及行业标准起草审核单位、“十三五重点项目”课题研发基地、建材行业标准化进程领军企业。

Vice president unit of China Aerated Concrete Association, Associated member of European AAC Association, editor of national and industrial AAC standards, R&D base of "key projects of the 13th five year plan", leading enterprise in standardization process of building materials industry.

整线系统服务

Whole AAC Plant Solution Service

市场调研、原料分析、定制化规划、设计制造、工程指导、专业培训、售后回访。

Market research, raw material analysis, customized planning, design and manufacturing, engineering installation guidance, professional training and after-sales return visit.

绿色可持续发展

Green Sustainable Development

低碳节能智能化工厂、环保降噪、轻质高效、保温防火绿色建筑材料。

Low carbon emission, energy-saving, intelligent, environmental protection and noise reduction, thermal insulation and fire prevention.



如何开始一个AAC生产线项目？

HOW TO START AN AAC PLANT PROJECT ?

市场调研 Market Research



前期调研对任何一个项目的开展都是非常重要的。科达新铭丰专业的市场营销团队及办事处分布在全国乃至世界各地，为您提供行业内一手市场信息，协助您进行项目前期考察调研。

Preliminary research is very important for starting a business. We have professional marketing teams and agents around the world to provide you with first-hand market information and assist you in the preliminary investigation and research of the project.



我们致力于“做世界一流的蒸压加气混凝土整线系统供应商”，我们的营销团队将以更加长远的目光考虑您的事业和整个行业的发展，并为您提供专业的建议和服务。

We are committed to "be a world-class supplier of AAC whole plant solution" so we will consider the development of your career and AAC industry with a longer-term vision, and provide you with professional suggestions and services.

在项目立项申报阶段，我们的专业团队将协助您进行项目可行性研究，环境营销评价。在项目过程中及项目售后服务时，如有任何涉及项目的专业申报需求，我们都将竭诚为您服务。

In the project initiation and application stage, our professional team will assist you in project feasibility study and environmental marketing evaluation. In the process of the project and after-sales service, if there is any professional application demand related to the project, we will serve you wholeheartedly.

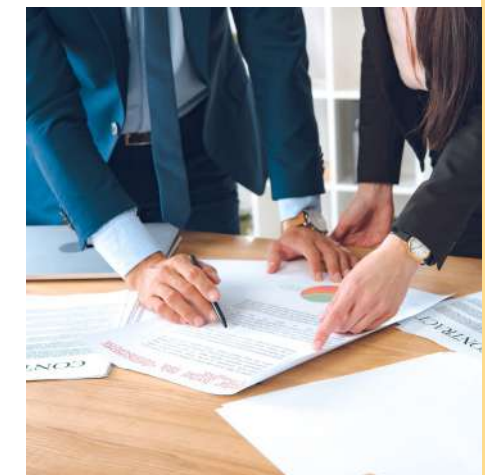

工艺服务 RAW MATERIAL INVESTIGATION

蒸压加气混凝土是以硅质材料(砂、粉煤灰及含硅尾矿等)和钙质材料(石灰、水泥)为主要原材料,掺加发气剂(铝粉、铝粉膏)及其它材料,通过原材料制备、配料浇注、钢筋组网(生产板材用)、静养发气、脱模切割、釜前编组、高压蒸养、出釜打包等工艺过程制成的轻质多孔硅酸盐制品。

Autoclaved aerated concrete is made of siliceous materials (sand, fly ash and silicon containing tailings, etc.) and calcareous materials (lime and cement) with aerating agent (aluminum powder, aluminum powder paste) and other materials, through the production process of raw material preparation, batching and pouring, reinforcement section (for production of panel materials), pre-curing and aerating, demoulding and cutting, grouping before autoclaving, high-pressure steam autoclaving and packing.



我们提供专业的工艺原材料分析及配方试验。我们的实验中心常年收到来自世界各地的客户的原料寄样,每年平均为国内外客户进行约600多次原料分析及配方试验。

We provide professional process raw material analysis and formula test. Our experimental center receives raw material samples from customers all over the world, and carries out more than 600 raw material analysis and formula tests for customers every year.

为响应国家绿色发展模式,我司进行固体废弃物的利用研发,如:粉煤灰、花岗岩、焚烧生活垃圾、瓷光泥、铅锌尾矿、金尾矿、萤石尾矿、石粉等。可通过分析及工艺配方的试验研究,作为主要硅质原料来生产蒸压加气混凝土产品。

In response to the requirement of green economic development, We do research and development on the utilization of solid wastes, such as fly ash, granite, incineration of domestic waste, porcelain clay, lead-zinc tailings, gold tailings, cocoon stone tailings and stone powder, etc. Through analysis and experimental research on process formula, a certain proportion of solid wastes can be used as silica raw materials.

确定合适的生产线产型及配置 CHOOSE AN APPROPRIATE SOLUTION

产能选型 CAPACITY SELECTION

| 方案系列 SOLUTION SERIES | 以300天计常规年产量 OUTPUT/ 300 DAYS (m ³ /year) | 常规建设土地面积 SUGGESTED LAND AREA (m ²) |
|-------------------------|---|--|
| K S | 100,000-150,000 | 15,000-20,000 |
| K S. Plus | 150,000-200,000 | 20,000-25,000 |
| K S. Max | 200,000-250,000 | 25,000-30,000 |
| K S. Pro Max | 300,000-600,000 | 30,000-40,000 |

我们拥有多种类型的坯体尺寸线型设计,包括不限于,4.2m*1.2m*0.6m,4.8m*1.2m*0.6m,5m*1.2m*0.6m,5.2m*1.2m*0.6m,5.4m*1.2m*0.6m,6m*1.2m*0.6m,6m*1.5m*0.6m等。此外,在实际项目方案设计过程中,科达新铭丰的专业团队会完全根据您的产能、成品包装需求、实际土地面积、当地物流、气候、环保政策、以及您的预算等综合影响因素,为您量身定制合适的整线系统解决方案。

We have different cake size production line designs, including but not limited to, 4.2m*1.2m*0.6m, 4.8m*1.2m*0.6m, 5m*1.2m*0.6m, 5.2m*1.2m*0.6m, 5.4m*1.2m*0.6m, 6m*1.2m*0.6m, 6m*1.5m*0.6m, etc. Further more our engineers will provide customized plant solutions depending entirely on all the relevant factors and conditions, such as available space, production capacity, climate, packaging, logistic, budget, and much more.

环保
ECO-FRIENDLY

智能
SMART

节能
ENERGY SAVING

耐久
DURABLE

KEDA SureMaker

AAC生产工艺流程图

AAC PRODUCTION PROCESS

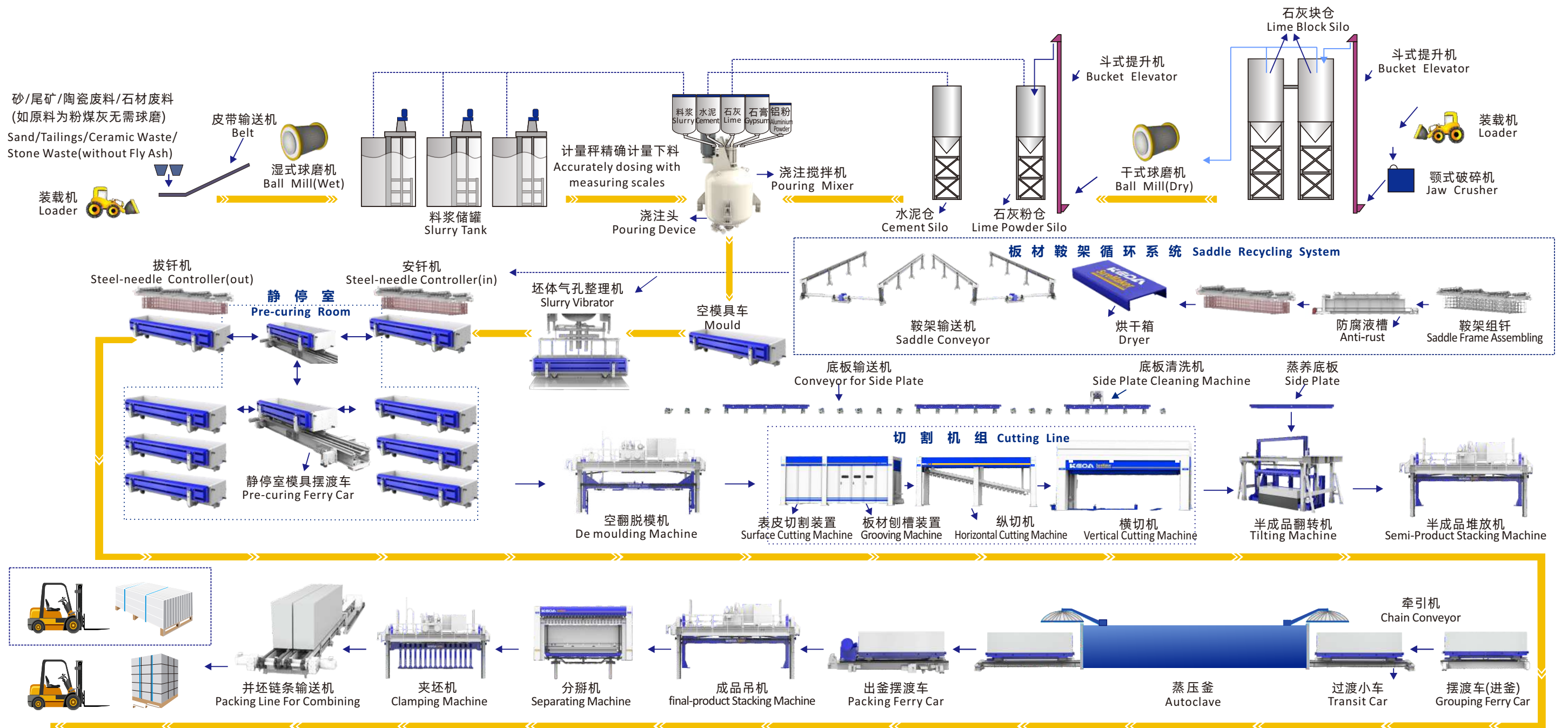

工艺流程 PRODUCTION PROCESS

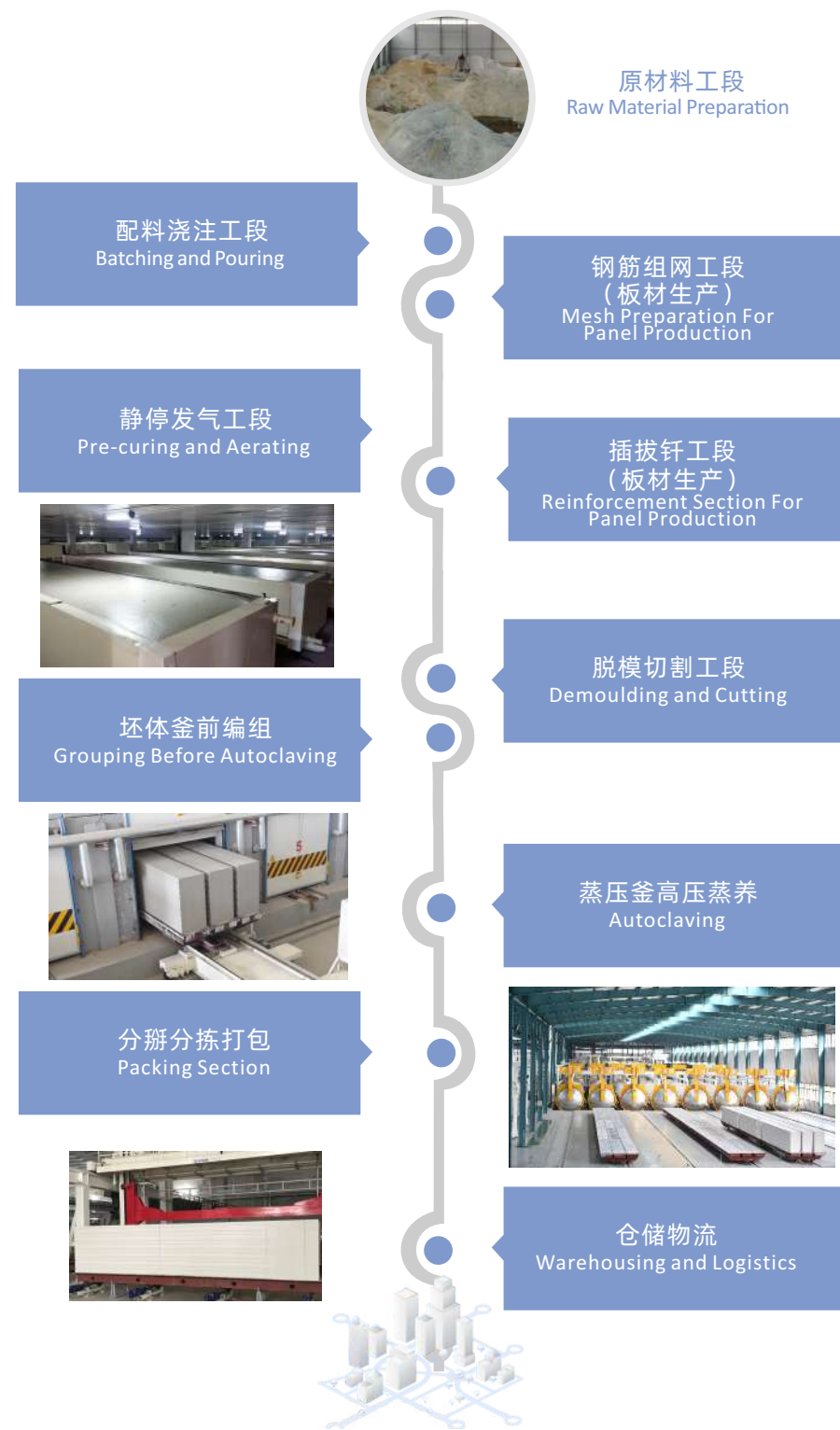

设备优势 EQUIPMENT ADVANTAGES

- 专利设计 (Patented Design)
- 搅拌效率高 (High Mixing Efficiency)
- 能耗更低 (Lower Energy Consumption)
- 工艺品质更稳定 (Stable Process Quality)

料浆的充分搅拌对于确保产品工艺品质有着至关重要的作用。科达新铭丰国内首创的双层十字桨叶加模块式导流筒设计，便于生产B03-B07产品，保证搅拌效果的同时，能耗更低。

The full mixing of slurry plays an important role in ensuring the process quality of products. Our patented design of double-layer cross blade and modular guide cylinder can ensure the mixing effect with lower energy consumption, which is good for producing AAC of different densities from 250kg/m³ to 700kg/m³.

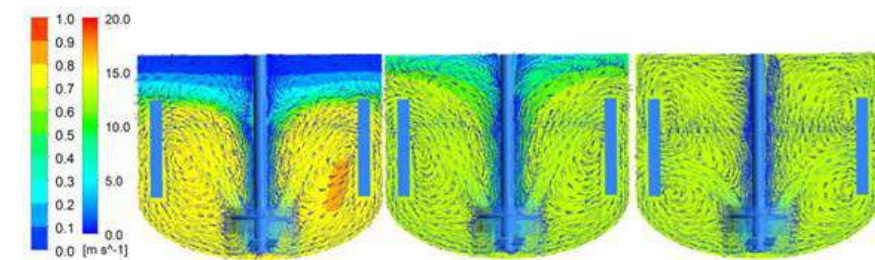

- 专利设计 (Patented Design)
- 避免大气泡集群 (Avoid Large Bubbles)
- 自动升降和浇注 (Lifting Type Discharge)
- 避免脱模油冲脱 (Avoid Flushing Oil Away)

升降式浇注头可以自动下降到模具内进行浇注，并随着料浆流量和模具的液位变化，自动调整浇注头的升降速度和高度，有效减轻料浆的飞溅和大气孔的集群产生。浇注头的结构经过专利设计，可有效减轻料浆对脱模油层的冲击和由此带来的脱模粘料。

The pouring device outlet can be automatically lowered into the mould for pouring, and the height of the outlet can be automatically adjusted with the change of slurry flow and the mould slurry level, which can effectively reduce the splash of the slurry and the cluster of large pores. The outlet is specially designed to cushion the huge flow pressure, which can effectively avoid flushing the mold oil layer away.

设备优势 EQUIPMENT ADVANTAGES



- 专利设计 经有限元分析
Patented Design & Finite Element Analysis
- 刚性良好 稳定耐久
Good Rigidity, Stability & Durability
- 特殊选材 整体加工
Integral Processing Technology

蒸养底板拥有发明专利，设计经过有限元分析。底板上平面受力负载变形量 $< 1/1000$ ，刚性良好，蒸养底板通过机床整体加工，保证加工侧板时厚度误差不超过 $\pm 1\text{mm}$ ，合模时不会造成模具胶条受力不均而过早破坏和漏浆。切割的稳定性和精度高，产品耐久性好。

The patented design of the side plate has been analyzed by finite element method. The load deformation of the plane on the side plate is less than $1/1000$, the rigidity is good. The side plate is processed as a whole, and the processing error does not exceed $\pm 1\text{mm}$, so that it can be perfectly combined with the mould without slurry leakage. The high quality of the side plate can ensure the stability and accuracy during cutting.

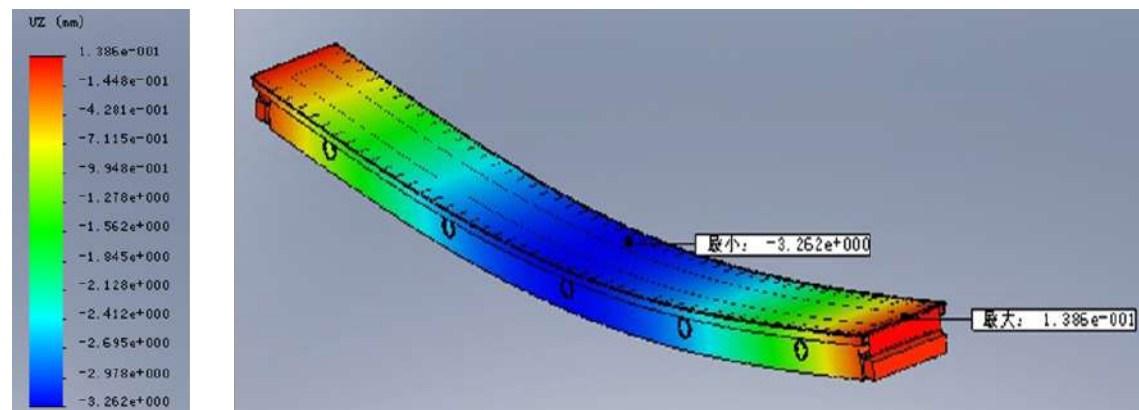

模具采用型钢做骨架分别焊接，骨架焊接完成后封板组焊，保证刚性，不易变形。开合模拐臂进行特殊设计，保证底板处于压紧状态，不会出现漏浆和倾斜。

The framework of the mould is made of section steel and welded respectively. The sealing plate shall be assembled and welded after welding the framework to ensure that the mould has good rigidity. With the special design of the mould crank arm, there is no slurry leakage while mould closing.



模具车 Mould

设备优势 EQUIPMENT ADVANTAGES

刨槽机配置精细化去面包头刮刀，斜刀粗刮 + 直刀精修，保证坯体表面平滑。智能刀库的自动换刀设计，可在六种刨槽切割尺寸间自由切换，无需人工换刀。

Fine bread head scraper, oblique knife rough scraping & straight knife fine scraping to ensure the smooth surface of the green cake. Smart grooving cutters changing system can change cutters automatically to meet different cutting requirements of panel grooving sizes.

自动旋转 更换刨槽刀 Cutters Can Be Changed Automatically



板材刨槽装置
Grooving Machine



纵切机 Horizontal Cutting Machine

- 专利设计
Patented Design
- 超平滑薄板切割
Super Smooth & Thin Panel Cutting
- 多对挂丝柱 独立可调
Multiple Pairs Of Independent Hanging Wire Posts
- 无沉降裂纹 无崩尾
No Settlement Crack Or Collapse

为了解决沉降裂纹的问题，科达新铭丰研发了一种斜拉梁结构纵切机。在斜梁上设置多对挂丝柱，每对挂丝柱只挂一根钢丝。切割进行时，多根钢丝逐次切入坯体，在垂直方向不重合，避免产生沉降裂纹或尾部崩坏。每个挂丝柱可微调更有利于保证切割精度。

In order to solve the problem of settlement crack, we have developed the cable-stayed beam horizontal cutting machine. Multiple pairs of wire hanging columns are set on the inclined beam, and only one steel wire is hung on each pair of wire hanging columns. With the special design, the settlement crack or tail collapse can be avoided. Each hanging wire post can be adjusted, which is more conducive to ensure the cutting accuracy.

设备优势 EQUIPMENT ADVANTAGES



横切机 Vertical Cutting Machine

科达专利经典版横切机设计，切割摆框可进行低频率、大幅度的摆动。配置导轨滑块对摆动幅度进行定位，摆动精度高，从而使切割表面更加光滑。机械同步式提升框体结构，保证坯体提升平稳无晃动。

在新一代横切机设计中，将坯体举升装置设置在地下，简化横切机结构，优化空间，并且可选配自动换钢丝装置。

The swing frame of vertical cutting machine equipped with guide rail slider can swing with low frequency and large amplitude, so as to ensure the swing accuracy and make the cutting surface more smooth. The mechanical synchronous lifting frame structure ensures the stability of green cake lifting without shaking.

In the new generation design scheme, the green cake lifting device can be set under the ground to simplify the structure of the vertical cutting machine, optimize the space, and the automatic steel wire replacement device can be an option.



半成品翻转机 Air Tilting Machine

半成品翻转机采用悬挂式设计，降低土建成本和施工难度。可额外设置等待工位，适用于大产能生产线，提高生产效率。结构特殊设计，顶皮和底皮可直接掉入废浆坑中，避免设备积料影响定位精度。

Air tilting machine can reduce civil construction cost and difficulty, an additional waiting station can be set, which can improve production efficiency. With the special structure design, the upper and bottom layers can directly fall into the waste slurry pit.

- 专利设计
Patented Design
- 降低土建成本和施工难度底
Easy Construction & Low Cost
- 干净卫生 生产效率高
Keep Clean & Efficient

设备优势 EQUIPMENT ADVANTAGES

釜后干掰机，采用固定分掰框+底板升降装置。通过导向柱+机械齿轮齿条+液压油缸同步，保证设备运行的平稳性和运行精度的耐久性。

湿掰机采用电动智能分掰模式，分掰效率高、无需液压，维护简单，适用于平进釜工艺。

White cake separating machine adopts the fixed separating frame with cake lifting device. With the upgraded structure design, we can ensure the smooth running and durability of action precision.

The green cake smart separating machine can separate panels of different specifications intelligently which is suggested for the flat cake autoclaving production process technology.



分掰机 Separating Machine

全智能自动打包系统 Fully Automatic AAC Packing Section

同模板材砌块的分掰、分拣 Separate and Sort Panels & Blocks Of One Cake

生产节拍快、运行效率高 High Operation Efficiency

钳式夹坯机经特殊设计，运行时定位精准，可平稳升降。15组夹头均设置球阀，可独立动作，便于不同规格板块同模生产。夹头松开，坯体即可沿长度方向行走，节省运行时间。

The clamping machine can walk smoothly and accurately to the specific position. It equipped with 15 pairs of collects with independent ball valves, which is convenient for transporting the blocks and panels produced by the same mould to different conveyor chains. When the collects are released, the products can be transported to the next station immediately through the conveyor which greatly saves the operation time.



夹坯机 Clamping Machine

产线的规划

PRODUCTION LINE PLANNING

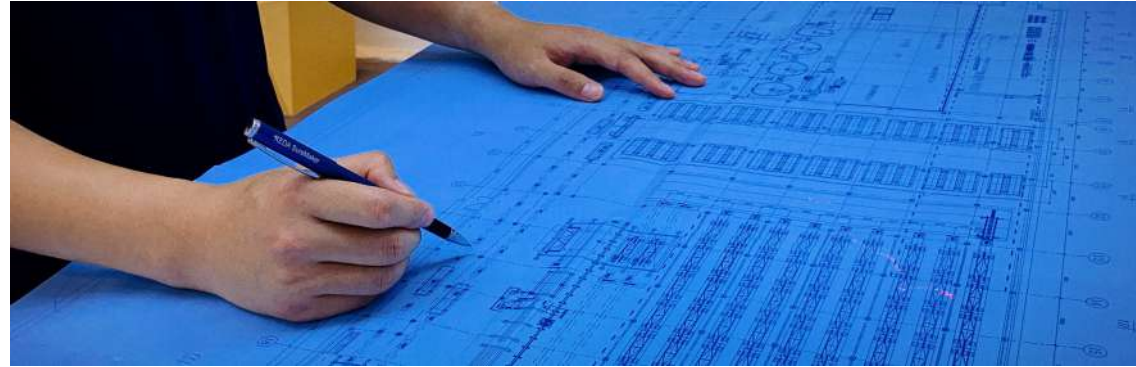

“ 我们的专业团队拥有数百个成功项目的规划经验，我们致力于打造绿色、低碳、环保、智能化新发展理念的蒸压加气混凝土工厂，引领推动行业绿色低碳发展。

With rich experience from hundreds of successful projects, we are committed to building AAC plants with the development concepts of reducing carbon footprint, environmental protection and intelligence, leading and promoting the development of the industry.

绿色环保

Environmental Protection

- 科技创新：优化工艺流程、开发高效节能装备；
- 低碳减排：余热利用、光伏发电、替代化石燃料、零废水工艺、节能系统；
- 以人为本：隔音降噪、绿化通风采光、人机分离；
- 信息化：智能数据、互联互通、环境检测；

· Scientific & Technological Innovation: optimize process flow, high-efficiency and energy-saving equipment.

· Reduce Carbon Footprint: heat utilization, photovoltaic power generation, replacing fossil fuels, zero waste water discharge.

· People Oriented: occupational health, safety and environmental management, sound insulation, ventilation and lighting, man-machine separation.

· Informatization: intelligent data, interconnection, environmental detection.

节能系统

Energy Saving System

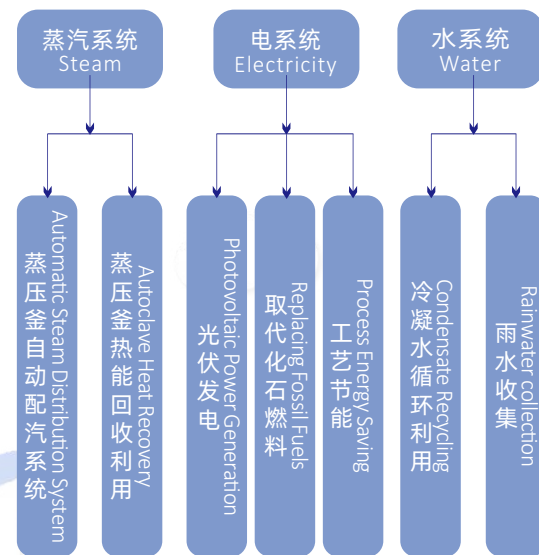

立切立蒸 Vertical Cake Autoclaving:

在立切立蒸的方案中，工厂设计紧凑、产品分拣包装便捷、是经典的设计方案。

The plant design is compact and convenient for the product sorting and packaging. It is the classic design of layout planning.



立切卧蒸 Flat Cake Autoclaving:

立切卧蒸系列方案中，可选配釜前湿掰工艺或釜后分掰工艺，该工艺更加适用于板材的生产。

The flat cake autoclaving is recommended for producing AAC panel, and the green cake separation or the white cake separation can be options.

在我们的方案中，坯体均垂直放置进行切割，从而保证最佳的切割精度。在产品蒸压前对坯体进行刨槽、或选配手持孔加工。我们的设计是灵活根据客户的具体需要而量身定做的，也可根据您的需要为您定制单头釜或双头釜方案规划方案。

According to our design concept, the cake is cut in an upright position which ensures perfect cutting precision and grooving of the cake before autoclaving. Our design is flexible and customized according to the specific needs of customers. Single head autoclave or double head autoclave can be options according to your needs.

板材大循环

Automatic Reinforcement Saddle Frame Cycle System

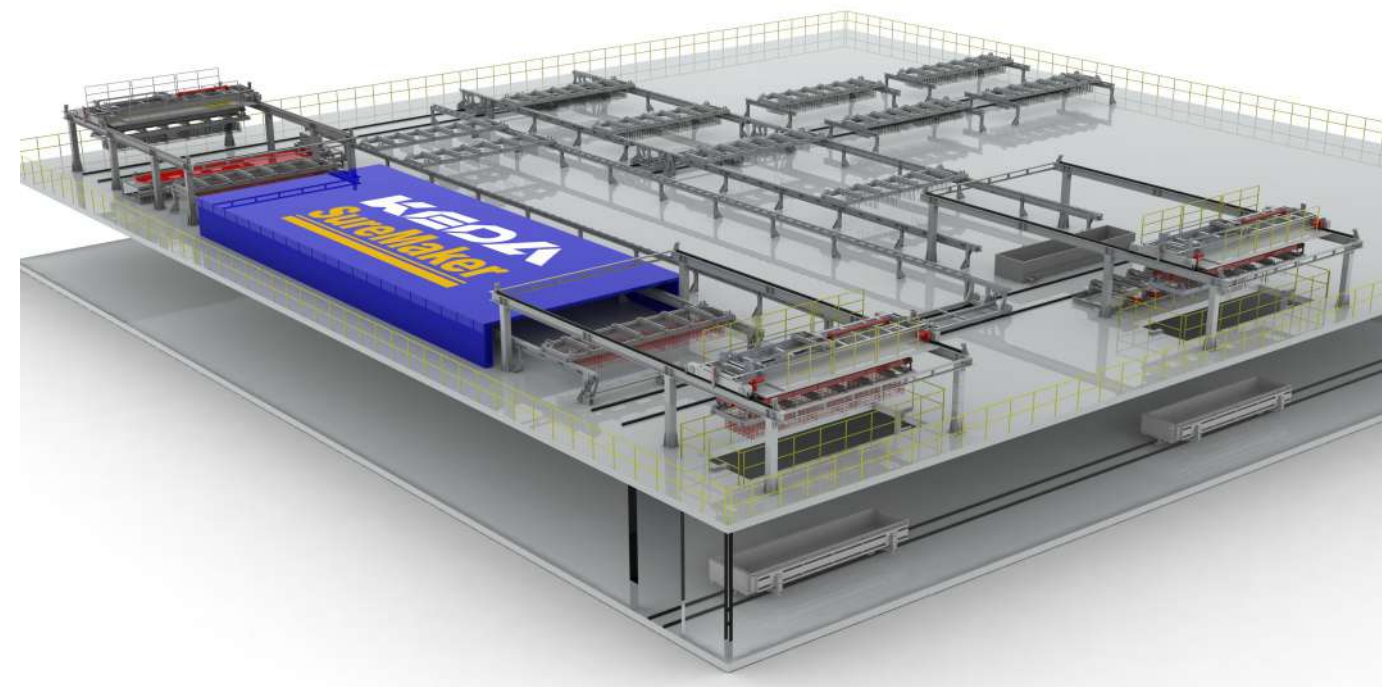

中央集成控制系统

CENTRAL INTEGRATED CONTROL SYSTEM



“生产线中央集成控制系统”，采用TCP/IP以太网协议进行数据交互，标准化程度高，通用性强，实现人机分离，互联互通。集成了视频监控系统，可以直观了解装备运转情况，系统可自动判断设备状态和工作条件，数字化运维生产过程。同时，集成故障报警、诊断和排障处理系统，协助维护人员快速排除故障，恢复生产线运转。

"Central integrated control system of AAC production line" adopts TCP / IP Ethernet protocol for data interaction, with high degree of standardization and strong universality. It realizes man-machine separation and interconnection. It integrates video monitoring system, which can intuitively understand the equipment operation and maintenance production process, and integrate fault alarm diagnosis and troubleshooting system to assist maintenance personnel to quickly eliminate faults and restore the operation of the production line.

如何执行项目设计阶段的工作?

HOW TO IMPLEMENT THE PROJECT DESIGN?

当项目生效时，根据项目需求每个项目都会成立项目设计专属团队。在售中即项目设计服务阶段，每个专业领域都安排一对一的专业人员，负责协调推动项目服务，解答客户疑问。

An exclusive project technical design team will be organized for each project. During the project design service stage, one-to-one professionals will be arranged in each professional field to coordinate and promote the project service and answer customers' questions.

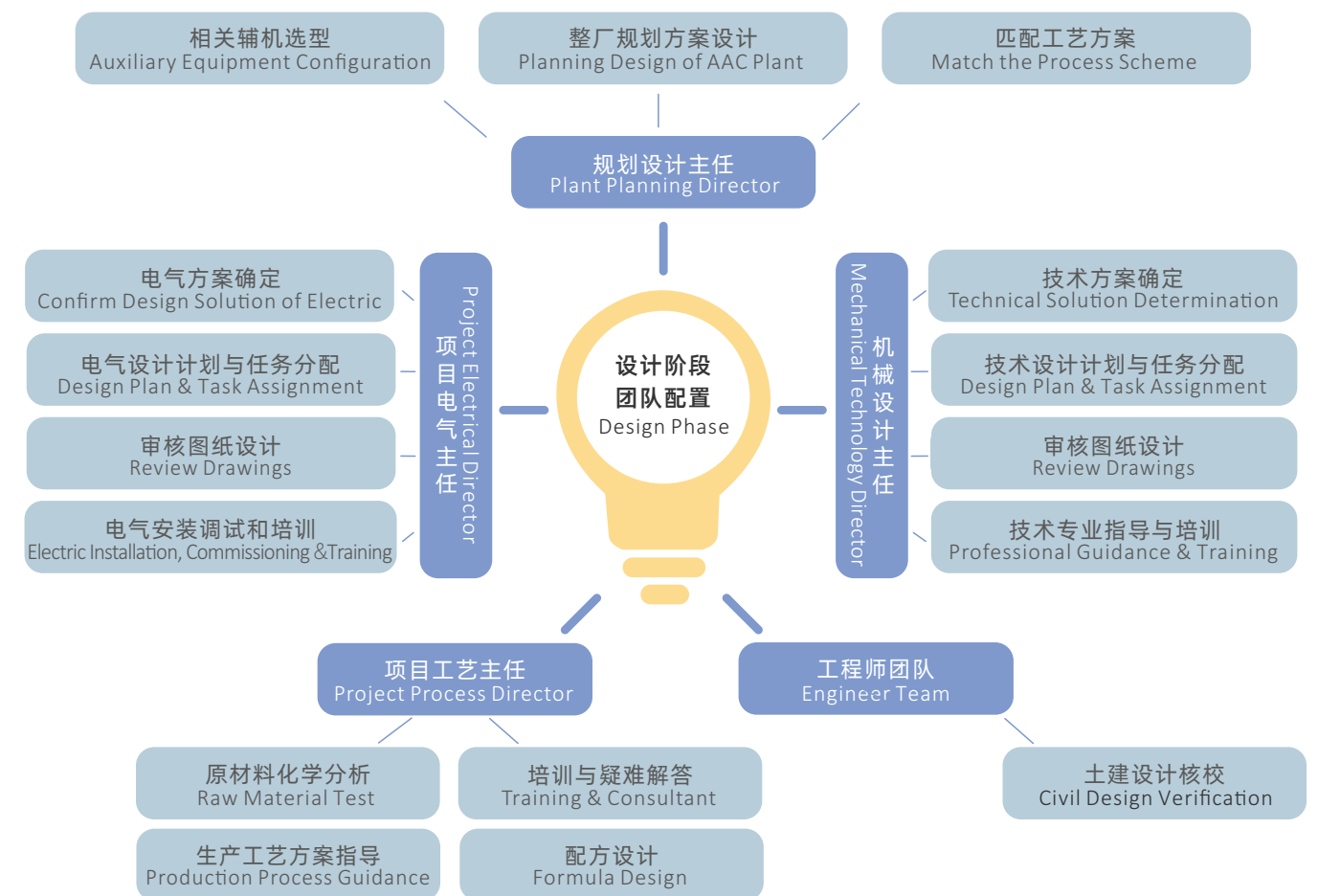

如何保证产品质量？

HOW TO ENSURE THE QUALITY CONTROL?

■ 以标准引导质量 QC by Standards

公司建立了逾百项企业标准、几十项产品企业标准。以标准促进产品质量，获得标准化管理先进单位。通过ISO9001质量管理体系认证和欧洲CE认证。

We have established hundreds standards of process, operation and inspection to control product quality. Passed ISO9001 quality management system certification and European CE certification.

■ 以检测手段控制质量 QC by Detection Testing

完善的量具管理体系，配备动平衡测试机、超声波探伤仪、振动测试仪、激光测距仪、数字化水平仪、声级计、红外测温计等等精密的电子测量设仪器设备。通过专业检测人员，用精密的检测仪器、设备检测控制产品质量。

Perfect measuring tool management system, equipped with dynamic balance tester, ultrasonic flaw detector, vibration tester, laser rangefinder, digital level meter, sound level meter, infrared thermometer and other precision electronic measuring equipment. Use precision testing instruments and equipment to test and control product quality.

■ 以信息化管理质量 QC by Informatization

公司打造了包括ERP系统、MES系统、及PDM系统等多款生产运营数字化办公平台。借助信息化系统和多年的数字化管理经验，建立了各项产品质量管控流程，强化了质量管理流程。产品质量信息透明、质量结果长期可追溯。

With the ERP system, MES system and PDM system, we strengthen the quality management process, transparency of product quality information and long-term traceability of quality results.

■ 以出厂调试验证质量 QC by Ex-factory Commissioning

公司建立调试平台，设立调试专用电柜和液压站，专门划定大面积的调试区域。要求每台设备在部装完成后，必须在出厂前整机组装，并进行电气和液压调试，确保产品出厂性能。

After assembly of each equipment, the electrical and hydraulic commissioning must be carried out before shipping to the plant to ensure the best performance.

■ 以考核强化质量责任 Strengthen QC Responsibility by Assessment

项目安装施工强力推行安装过程质量自检和专检相结合的质量控制制度。对配套产品进行进场和调试的检验评价，用检验评价结果对合作供应商进行考核。以共同品牌的塑造强化全面质量责任。

The quality control system which combining self-inspection and special inspection of the installation process is strongly implemented, and the quality assessment of each installation-related party is clearly defined. The results of the inspection and evaluation of onsite ancillary products commissioning will form the basis for our evaluation of suppliers.

如何确保工程服务？

HOW TO ENSURE ENGINEERING SERVICES?

配置专业的工程服务施工团队
Professional Engineering Service Team

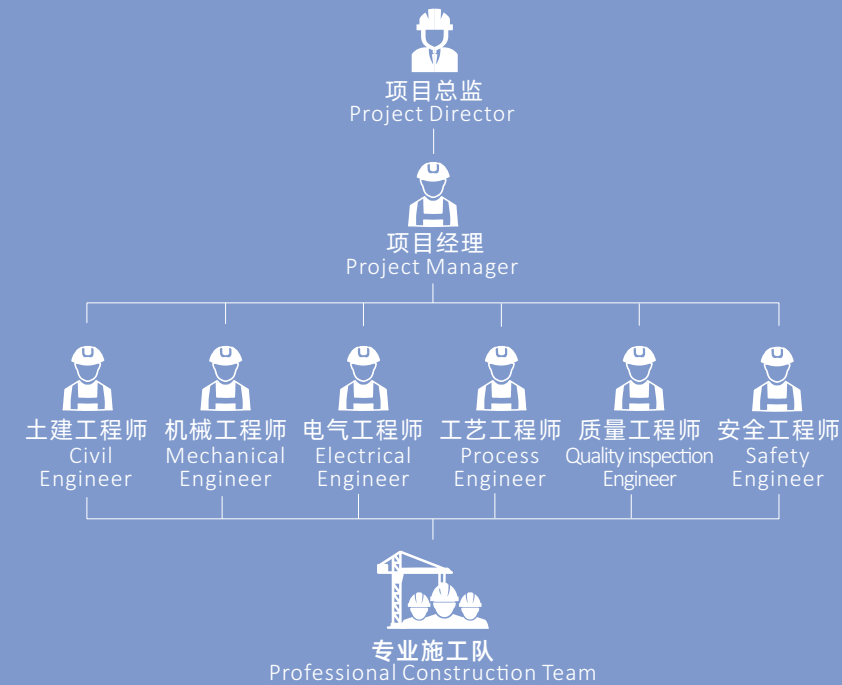

工程实施服务：项目交底、提供土建指导、设备指导安装、设备试生产调试、生产工艺优化调试。

Project implementation services: Project disclosure, civil engineering guidance, equipment installation guidance, equipment trial production and commissioning, production process optimization and commissioning.

工程援助响应：在全国各地区设立工程服务办事处，可快速响应服务需求。数字化工程服务平台，可提供远程服务。

Engineering assistance response: Our engineering service team can offer you the quick response of the engineering service needs. Digital engineering platform and remote service.

完善的配件体系：售后服务采购直通热线、线上平台人工服务。

Perfect accessories system: Purchasing direct hotline and online platform and manual service.



如何落实项目培训? HOW IS THE PROJECT TRAINING?

科达加气 K 学院实用星标课程:
Practical Star Standard Course Of KEDA Academy:

- AAC原材料工艺细节和生产工艺控制
 - AAC配合比计算和浇筑工艺要求的详细说明
 - AAC生产工艺流程和控制要求
 - AAC生产过程质量问题分析及解决方案
 - AAC生产线设备工艺流程及日常注意事项
 - AAC生产线设备的日常维护
 - AAC设备操作流程及故障排除
-
- AAC raw material process details and production process control
 - Detailed explanation of AAC batching process requirements
 - AAC production process flow and control requirements
 - AAC production process quality problem analysis and solutions
 - AAC production line equipment process flow and daily precautions
 - Daily maintenance of AAC production line equipment
 - AAC equipment operation process and trouble shooting

拓展兴趣课程:

Expand Interest Courses:

- 蒸压加气混凝土发展史及市场现状
 - 钙硅反应理论
 - 蒸压加气混凝土生产过程中蒸压内的热平衡研究
-
- Development history and market status of the AAC industry
 - Calcium silicon reaction theory
 - Study on heat balance in the AAC production process



如何落实售后服务体系? HOW IS THE AFTER-SALES SERVICE SYSTEM?

完善的售后服务路径: 针对市场、工艺、机械、电气、配件等建立多维度售后服务团队, 专业答疑。此外, 公司成立项目回访团队, 定期对老客户的生产线进行回访, 并提供工厂运营情况检测评估优化服务。协助客户工厂广宣设计工作。项目完成后, 如有项目申报的相关资料需求, 可提供相关技术支持。

The perfect after-sales service path: A multi-dimensional after-sales service team is established for marketing, process, mechanical, electrical and accessories, etc., to answer questions professionally. In addition, the company has set up a project review team to visit the production lines of our customers regularly. We will provide services to optimize the inspection and evaluation of factory operations. Assist customers in the design of factory appearance and advertisement. After the completion of the project, if there is a demand for information related to the project declaration, we can provide relevant technical support.

高效物流结算 LOGISTICS & SETTLEMENT

一站式物流运输方案 One Stop Logistics Transportation Scheme



合作国际著名船公司如：OOCL，ZIM，COSCO，马士基等及大型物流、船务公司及港口码头，可高效处理出口申报工作、为客户提供一站式物流运输方案。

Cooperate with international famous shipping companies: OOCL, ZIM, COSCO, MAERSK and other well-known logistics companies. Can support different kinds of transportation models and efficiently handle export declarations, provide customers with one-stop logistics transportation scheme.

多元化结算渠道 Diversified Settlement Channels

公司推出多元化结算渠道，包括电汇、即期托收，远期信用证，涉外银行保函，融资租赁等业务。合作中国出口信用保险公司为客户量身定制分期付款结算方案，多渠道满足客户对融资的需求；

Diversified settlement channels including telegraphic transfer, spot collection, (D/P, D/A), usance letter of credit, foreign-related bank guarantee, financial leasing, etc, and cooperated with China Export Credit Insurance Corporation to customize the installment settlement scheme of credit insurance for customers, etc.



高效清关单证支持 Efficient Customs Clearance Document Support

作为安徽省贸促会重点企业，可为合作客户及时提供普通产地证（CO）。在东南亚、南亚等区域国家，也可为客户办理优惠制原产地证（FORM-E, FORM-P, FTA等）提升清关效率，降低客户进口关税。

Timely provide ordinary certificates of origin (CO) for cooperative customers, and handle preferential certificates of origin (FORM-E, FORM-P, FTA, etc.) for customers in Southeast Asia, South Asia and other countries, so as to improve customs clearance efficiency and save cost.



项目全景 OVERVIEW OF AAC PLANT



终端产品的优势： THE EXCELLENT CHARACTERISTIC OF AAC :



轻质高强 Light Weight and High Strength

AAC制品重量为传统材料的1/3-1/10，有效减轻建筑自重，提高建筑抗震。
The weight of AAC products is 1/3 - 1/10 of that of traditional wall materials, which can effectively reduce the self weight of buildings and improve the seismic resistance of buildings.



防火阻燃 Fire Resistance

AAC制品为A1级不燃材料，100mm厚AAC墙体的耐火极限可达4小时。
The fire resistance of AAC wall with thickness of 100mm is up to 4 hours.



绿色环保 Eco-friendly

AAC制品的原材料和成品均为无机材料，其在全寿命期内均无毒无害，是真正意义上的绿色环保新型建材。
AAC products are non-toxic and harmless, can be recycled and are really green and environmental new building materials.



隔声吸音 Sound Insulation

AAC制品具有隔声和吸音双重性能，作为墙体时其计权隔声量可达40-60dB,完全满足建筑隔声要求。
AAC products have double functions of sound insulation and absorption. When they are used as walls, their weighted sound insulation can reach 40- 60db, which fully meets the requirements of building sound insulation.



尺寸精准 High Precision

高品质AAC制品误差仅为1mm左右，为高精度、高效率的装配化施工提供了可靠保证。
AAC is accurate in size and easy to process, which provides a reliable guarantee for efficient assembly construction.



防水抗渗 High Impermeability

AAC制品的内部是密闭不连通气孔，且使用专用施工工艺及配套材料，能有效阻止水分渗透。

As AAC is composed of many closed pores and constructed with special materials, it has high impermeability.



保温隔热 Thermal Insulation

AAC制品的干导热系数为0.055-0.17W/(m*k),与其他墙体材料相比，可有效提高建筑节能水平，降低使用能耗。
The dry thermal conductivity of AAC products is 0.055-0.17 w/(m*k), can effectively improve the level of building energy saving and reduce the energy consumption.



安全耐久 Safety and Durability

经过蒸压后的产品，性能稳定，拥有良好的耐久性。
After autoclaving, the product has stable performance and good durability.

终端产品应用

SCOPE OF APPLICATION



合作共赢

WIN-WIN COOPERATION



员工风采

WELCOME TO JOIN US

支撑科达人在漫漫征途上无悔前行的除了梦想抱负外，还有同事之间深深的情谊、员工对企业的认可和深爱之情。为增强员工的凝聚力、让员工在工作中感受到温暖快乐，我们积极开展了各种各样的文化活动及团建培训。这些年科达新铭丰发展蒸蒸日上、离不开每一位为科达奉献自己青春，努力拼搏的科达人，感谢有你，一路携手同行！

In addition to dreams and aspirations, the profound friendship between colleagues, the recognition and deep love for the enterprise support us to move forward on the long journey. These years our company has developed rapidly, which is inseparable from every employee who dedicates his youth and works hard for KEDA SUREMAKER.

体育时刻 — 活力四射

Sports Moment - Passionate & Energetic



文化活动

Activity



亲子夏令营
Children Summer Camp



春节写对联
Chinese New Year Couplets



女神节花艺
Women's Day Flower Activities

THANK YOU ALL
THE WAY



公司团建
Group Construction Of Company



头脑风暴讨论会
Brainstorming Session



公司秋季运动会
Autumn Games